

安装尺寸图

SLNSTALLATION DIMENSIONS

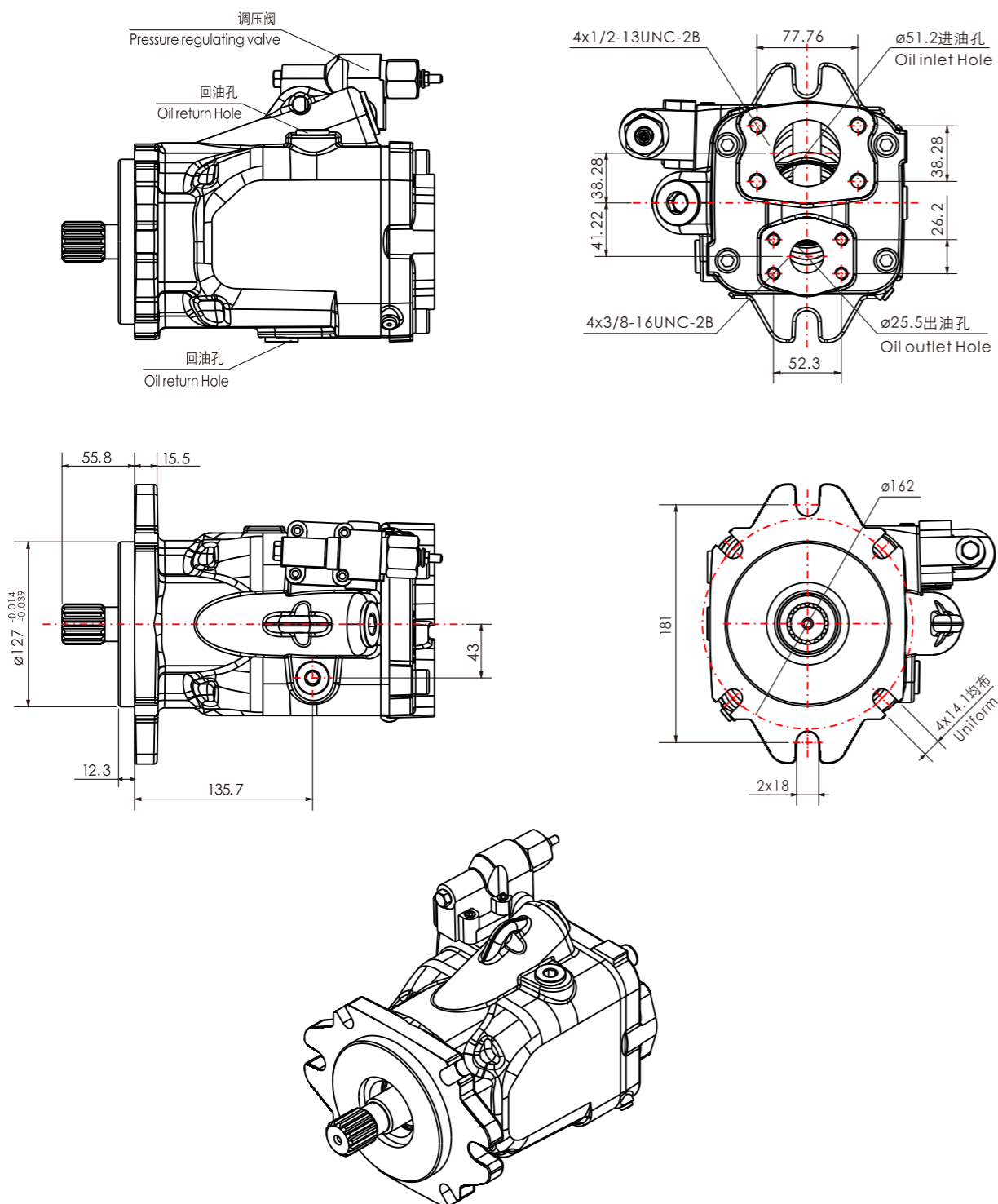

WA10VSO 柱塞泵系列

WA10VSO SERIES PISTON PUMPS

产品的特征和优点

- ① 开式回路轴向柱塞泵。
- ② 工作噪声很低，使用寿命长久。
- ③ 有多种控制范围，控制方式反应灵敏。
- ④ 该泵带有通轴驱动，可承装齿轮泵或者小于等于相同规格的轴向柱塞泵，即100%通轴驱动。

Features and Advantages

- ① Open circuit axial piston pump.
- ② Low noise level and long service life.
- ③ Versatile controller range.
- ④ The through drive is suitable for adding gear pumps and axial piston pumps up to the same size, i.e., 100% through drive.



WA10VSO是斜盘结构轴向柱塞变量泵，用于开式回路中的静液压传动。流量与传动速度和排量成比例，可通过调节旋转斜盘角度实现无级变量。

Variable pump in axial piston swashplate design for hydrostatic drives in an open circuit. The flow is proportional to the drive speed and the displacement. The flow can be steplessly varied by adjustment of the swashplate angle.

技术参数 (TECHNICAL PARAMETERS)

型号 Model	WA10VSO		
排量 Displacement	45mL/r	71mL/r	100mL/r
旋转方向 Direction of rotation	R- 顺时针Clockwise ; L- 逆时针Anticlockwise		
工作方式 Operation mode	开式回路 Open circuit		
工作压力 Operating pressure	280bar		
最大压力 Maximum pressure	350bar		
最大转速 Maximum drive speed	3600r/min		

型号编码 (WA10VSO SERIES TYPE CODE)

WA10VS O 71 DG R V S C N00

标识 Code	轴向柱塞元件 Axial piston unit
WA10VS	斜盘设计, 变量泵 Swashplate design, variable

标识 Code	工作模式 Operation mode
O	泵, 开式回路 Pump, open circuit

标识 Code	排量 Displacement	WA10V型
45	45mL/r	
71	71mL/r	
100	100mL/r	

标识 Code	控制设备 Control device
DG	两点直动式控制 Two-point control, directly operated
DR	压力控制 Pressure control
DFR	带液压流量控制 X-T 开启 With flow control, hydraulic, X-T open
DFR1	带液压流量控制 X-T 关闭 With flow control, hydraulic, X-T closed
DRG	远程压力控制 液压 With pressure cut-off, remotely operated, hydraulic
ED71	远程压力控制 电动控制 负极特性 12V
ED72	With pressure cut-off, remotely operated, electrical, negative characteristic 24V
ER71	远程压力控制 电动控制 正极特性 12V
ER72	With pressure cut-off, remotely operated, electrical, positive characteristic 24V
DFLR	压力、流量和功率控制(仅WA10V型) Pressure, flow and power control (WA10V only)

标识 Code	通轴驱动 Through drive
N00	无通轴驱动 Without through drive

标识 Code	安装法兰 Mounting flange
A	ISO 3019-2 (DIN) 2孔 Hole
B	ISO 3019-2 (DIN) 4孔 Hole
C	ISO 3019-1 (SAE) 2孔 Hole
D	ISO 3019-1 (SAE) 4孔 Hole

标识 Code	传动轴, 花键轴 ANSI B92.1a Drive shaft, Splined shaft
S	标准轴 Standard shaft
R	适合更高的输入扭矩 Higher input torque
U	缩小的直径, 不用于通轴驱动 Reduced diameter
W	扭矩更高, 不用于通轴驱动 Higher torque Parallel keyed shaft DIN 6885
P	不用于通轴驱动 Not for through drive

标识 Code	密封件 Seals
V	FKM氟橡胶 Fluor-caoutchouc

标识 Code	旋转方向(从传动轴上看) Direction of rotation Viewed on drive shaft
R	顺时针 Clockwise
L	逆时针 Anticlockwise

通轴驱动 (THROUGH DRIVE)

标识 Code	排量 Displacement (mL/r)			通轴驱动 Through Drive	
	45	71	100	Through Drive	
N00	✓	✓	✓	无通轴驱动 Without Through Drive	
有通轴驱动					
标识 Code	45	71	100	安装法兰 Flange	花键轴/轴套 Coupling for Splined Shaft
				ISO 3019-1	ANSI B92.1a
K01	✓	✓	✓	82-8 (S)	5/8 in 9T 16/32DP
K52	✓	✓	✓		3/4 in 11T 16/32DP
K68	✓	✓	✓	101-2 (B)	7/8 in 13T 16/32DP
K04	✓	✓	✓		1 in 15T 16/32DP
K07	/	✓	✓	127-2 (C)	1 ¼ in 14T 12/24DP
K24	/	/	✓		1 ½ in 17T 12/24DP
K17	/	/	/	152-4 (D)	1 ¾ in 13T 8/16DP

传动轴 (DRIVE SHAFT)

标识 Code	45	71	100	传动轴 Drive Shaft
ANSI B92.1a 花键轴 Splined Shaft				
S	✓	✓	✓	标准轴 Standard shaft
R	✓	✓	/	类似于轴 "S", 但适合更高的输入扭矩。 Similar to shaft "S" however for higher input torque.
U	✓	✓	✓	缩小的直径, 不用于通轴驱动。 Reduced diameter, Not for through drive.
W	✓	✓	✓	等同于 "U", 但扭矩更高, 不用于通轴驱动。 Higher torque, Not for through drive.
DIN 6885 平键轴 Parallel keyed shaft				
P	✓	✓	✓	不用于通轴驱动 Not for through drive

安装法兰 (MOUNTING FLANGE)

标识 Code	45	71	100	安装法兰 Mounting Flange
A	✓	✓	✓	ISO 3019-2 DIN 2孔 Hole
B	/	/	/	ISO 3019-2 DIN 4孔 Hole
C	✓	✓	✓	ISO 3019-1 SAE 2孔 Hole
D	/	/	/	ISO 3019-2 SAE 4孔 Hole

("✓": 可供货 Available; "-" : 准备中 Preparation; "/" : 无供货 Not Available;)

WA10VSO-45 安装尺寸图

WA10VSO-45 SLNSTALLATION DIMENSIONS

DFR/DFR1压力和流量控制 Pressure and Flow Control

顺时针旋转 Clockwise Rotation

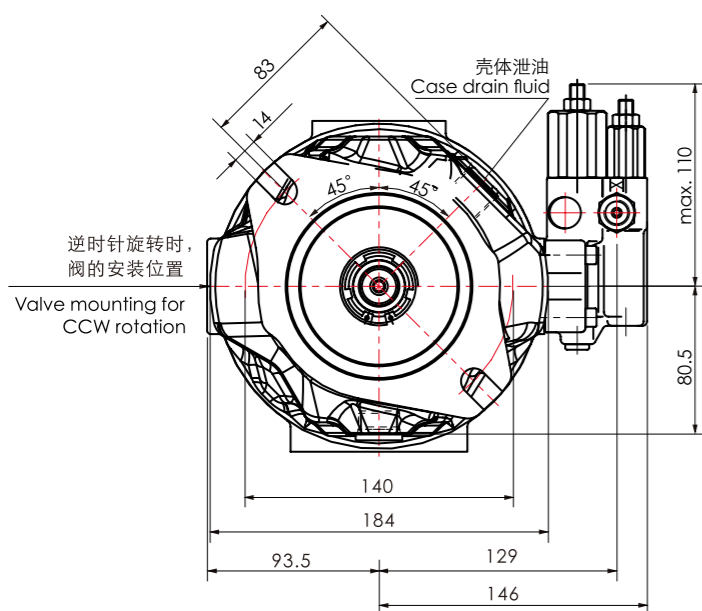
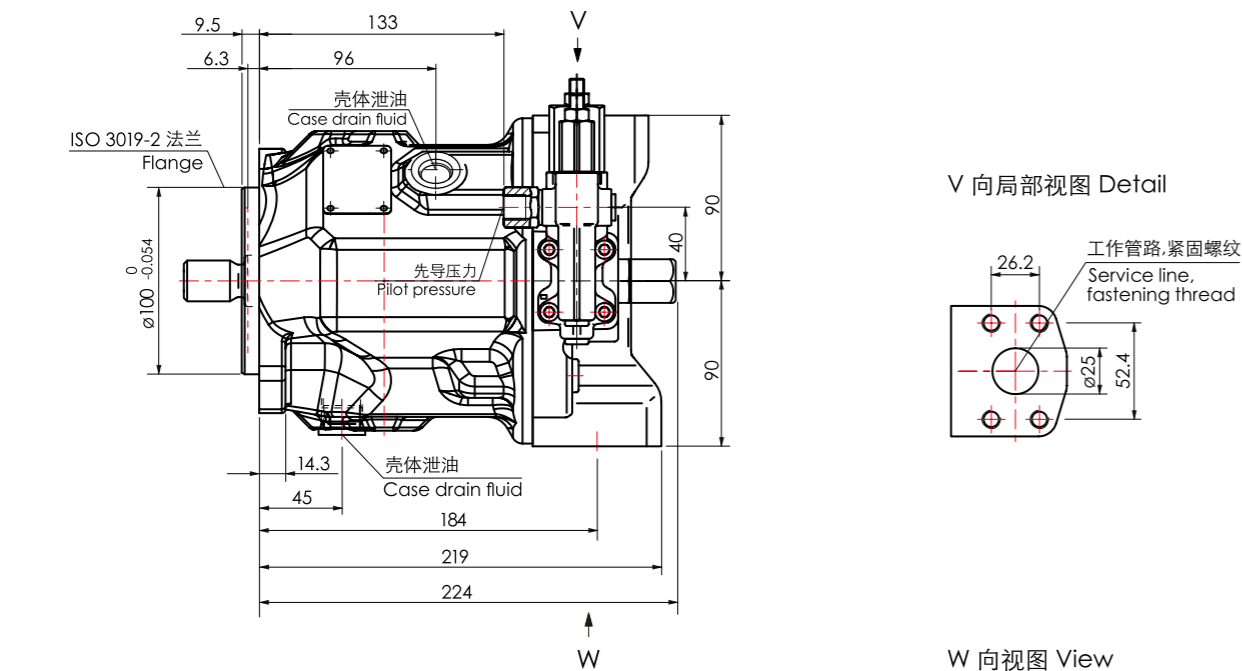

WA10VSO-71 安装尺寸图

WA10VSO-71 SLNSTALLATION DIMENSIONS

DFR/DFR1压力和流量控制 Pressure and Flow Control

顺时针旋转 Clockwise Rotation

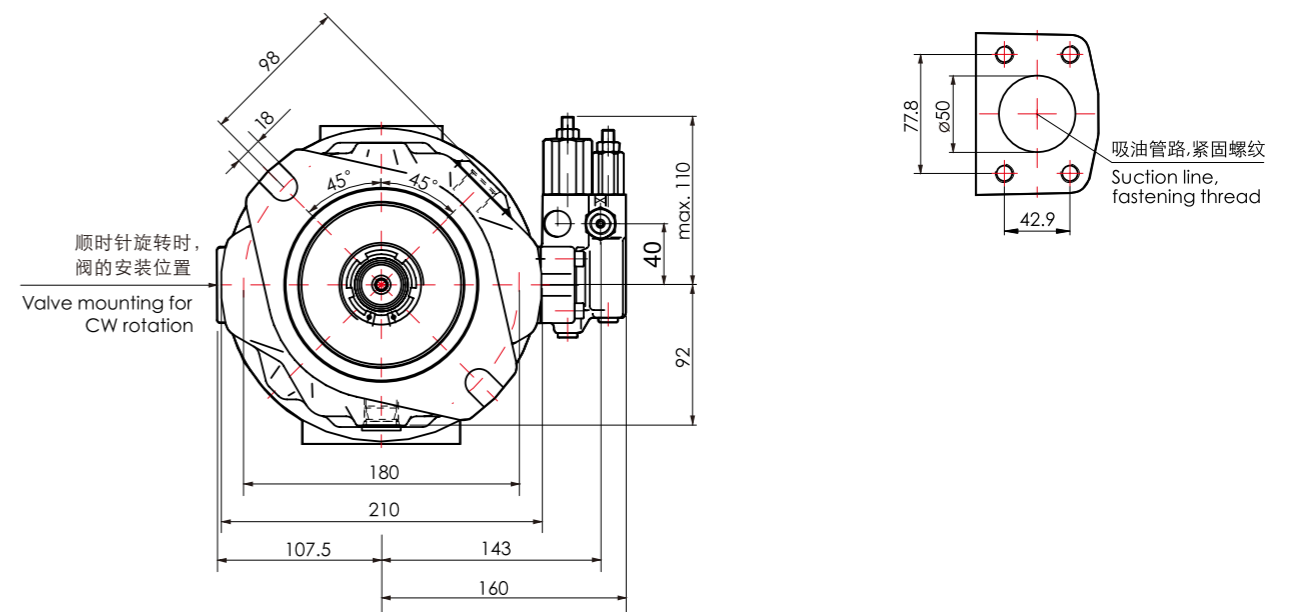
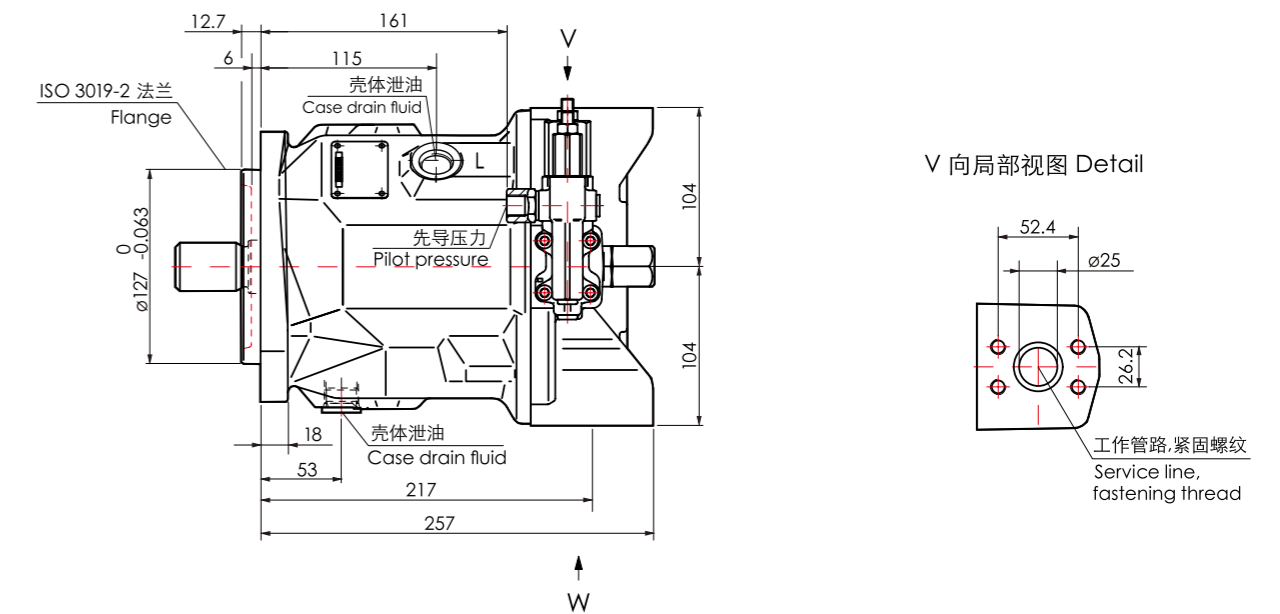

WA10VSO-100 安装尺寸图

WA10VSO-100 SLNSTALLATION DIMENSIONS

DFR/DFR1压力和流量控制 Pressure and Flow Control

顺时针旋转 Clockwise Rotation

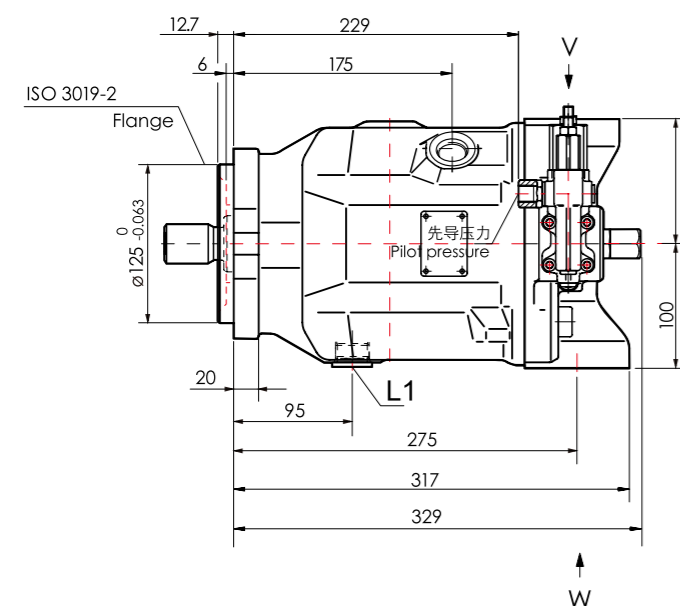

V 向局部视图 Detail

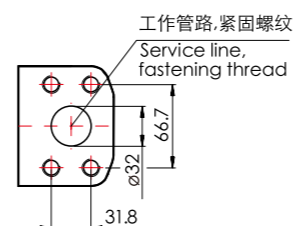

W 向局部视图 Detail

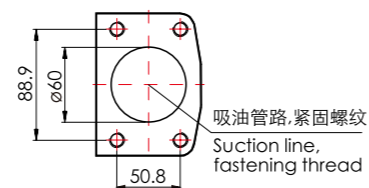

WA2FM 轴向柱塞定量马达 WA2FM AXIAL PISTON FIXED MOTOR

WA2FM是采用斜轴式设计的轴向柱塞定量马达,用于开式回路和闭式回路中的静液压传动,适用于行走机械和工业应用。

Fixed motor with axial tapered piston rotary group of bent-axis design, for hydrostatic drives in open and closed circuits. For use in mobile and stationary applications.

产品的特征和优点

- ① 输出速度取决于泵的流量和马达的排量。
- ② 输出扭矩随高低压侧之间的差压而增大。
- ③ 具有高功率密度、总效率高。
- ④ 具有尺寸小、设计经济。
- ⑤ 带密封柱塞环的一体式柱塞设计。

Features and Advantages

- ① The output speed is dependent on the flow of the pump and the displacement of the motor.
- ② The output torque increases with the pressure differential between the high-pressure and the low-pressure side.
- ③ High power density and high total efficiency.
- ④ Small dimensions and economical design.
- ⑤ One-piece tapered piston with piston rings for sealing.

技术参数 (TECHNICAL PARAMETERS)

型号 Model	56	63	80	90
排量 Displacement	56.1 mL/r	63 mL/r	80.4 mL/r	90 mL/r
最高转速 Max. drive speed	5000 rpm	5000 rpm	4500 rpm	4500 rpm
最高转速(间歇) Max. drive speed (Intermittent)	5500 rpm	5500 rpm	5000 rpm	5000 rpm
输入流量 Input flow	281 L/min	315 L/min	362 L/min	405 L/min
旋转方向 Direction of rotation	R- 顺时针 Clockwise ; L- 逆时针 Anticlockwise			
工作方式 Operation mode	开式回路 Open circuit ; 闭式回路 Close circuit			

